

Q & A:

1. How do I name a star/ make a donation?

- Fill in Nomination Form (to specify star location, nominee, words of thanks and nominator);
- Fill in Donation Form (to specify payment method);
- Send the above two forms with your cheque* or bank-in slip* to:

Mr. George Tam (SDP),
Wah Yan College, Hong Kong,
281 Queen's Road East, Hong Kong

(*Not applicable to credit card payments)

2. What are the payment methods available?

You may pay by cheque, credit card, bank transfer or Internet banking.

Cheque payable to / Bank account to be credited:

Wah Yan College, Hong Kong - SDP
Account no. 020-601-120-3059-6
Wing Lung Bank Ltd.

3. Is the donation tax deductible?

Yes, tax deduction is applicable in Hong Kong with the receipts we issue.

4. How do I know which stars are available?

By looking at the Star-chart on the SDP website at www.wahyan-psa.org/sdp.
(Stars are available on a first-come-first-served basis.)

5. Where can I find the Stars Chart, Nomination Form and Donation Form?

- The Principal's Office, Wah Yan College, Hong Kong;
- SDP website at www.wahyan-psa.org/sdp

6. After whom can I name a star?

Any person, living or deceased, or group, or institution that has contributed to the well being of Wah Yan or members of the Wah Yan community.

7. Can I nominate a person already nominated by someone else?

Yes, but the SDP Board may advise you to adjust the nominee's name to avoid inconsistency.

8. Can I use nicknames?

Yes, but the SDP Board will need to be satisfied that it is done in good taste and with the agreement of the person(s) involved.

9. Do I have to get approval from the person I nominate?

No, but the SDP Board may seek your assistance in contacting the nominee for his permission when deemed necessary.

10. Can I make more than one nomination?

Yes.

11. Can I nominate jointly with others as a group?

Yes.

12. Can I donate more than HK\$10,000 for one star?

Yes.

13. Can I be an anonymous nominator?

Yes.

14. Can I change the size and design of the star-plates?

No. The star-plates are standardized in size and design and the lengths of your inscriptions are governed by the design grids as shown in the Nomination Form.

15. When will the Wall of Stars be erected?

It will be erected upon the completion of the new school hall building with which it will coexist.

All nominations are subject to the approval of the Wah Yan College Hong Kong School Development Project Board.



Wah Yan College Hong Kong
School Development Project

SDP NEWS

FEBRUARY 2012

Wall of Stars - Fund Raising Scheme

Dear Alumni and Friends ,

We wish to thank you sincerely for all your kindness and generous support in the past, for without this support Wah Yan College would not be what it is today.

Now we ask you to help us *Reach for the Stars* as this is our major effort to make up the deficit of eighteen million, to complete our new building with its spacious school hall and indoor basketball court.

Here is our plan to attract people to give what they can. You can choose and nominate a star on the "Wall of Stars". The star is very appropriate as we have five stars on our school badge and our school annual magazine is called "The Star".

A chosen Star can represent or nominate a person or a group and will be a permanent tribute of gratitude and acknowledgement of your generosity in Wah Yan's history.

Please support our scheme and help us fill the "Wall of Stars".

Yours sincerely,



A. J. Deignan S.J.
Rev. Fr. A.J. Deignan, S.J.
Co-chairman



Patrick P.K. Wu
Dr. Patrick P.K. Wu, J.P.
Co-chairman

Wah Yan College, Hong Kong
School Development Project Board



Published by Wah Yan College Hong Kong School Development Project Board
281 Queen's Road East, Wanchai, Hong Kong. Tel : (852) 2572-2251 Fax : (852) 2572-9370

List of Donors and other SDP information available at the following websites :
Wah Yan College Hong Kong : www.wahyan.edu.hk
Wah Yan (H.K.) Past Students Association : www.wahyan-psa.org/sdp

Reach for the Stars

About the New School Hall Building

The new school hall under construction will have 1000 seats and be large enough to accommodate the whole school in an assembly. The stage, measuring 17 meters wide by 11 meters deep, will enjoy the luxury of being flanked by two side stages each 8 meters wide. Designed to be convertible into a competition size basketball court complete with spectator stands, the new hall will be an excellent multi-purpose venue for a wide variety of sports, artistic, social, as well as academic functions.

The covered playground, spacious and with a head clearance of 6.1 metres, will ensure the continuation of activities uninterrupted by adverse weather conditions. Convertible in parts to multi-function rooms and strategically located adjacent to the school lawn on the ground floor, it will become a popular centre of student activities.

Four new classrooms will be added to the top floor to facilitate split-class teaching, the implementation of which has been adopted by Wah Yan to improve the quality of education she provides.

Multi-functional and highly flexible, the new school hall building is envisaged to become the hub of activities that will enrich the learning experience of generations of Wahyanites to come.

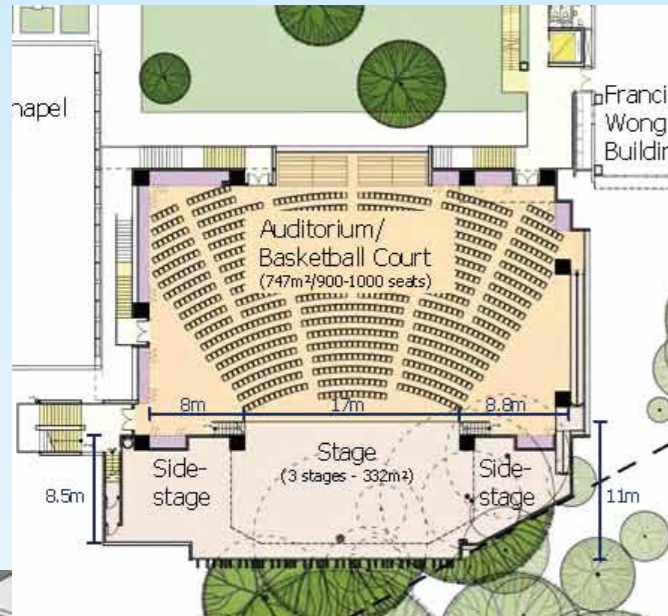

Funding
 The cost for the new school hall building is estimated to be HK\$107,700,000.
 We are currently **HK\$18,274,506** short in funds.
 Your further support in terms of donation is crucial!



Wall of Stars - Fund Raising Scheme

Name a star to give thanks and to help build the Hub of Wah Yan's Learning Experience!

For each **HK\$10,000** donation, the donor (nominator) may name one of the stars on the Wall of Stars after a person (nominee) connected with Wah Yan. The nominator may also add a short inscription to express his appreciation of the nominee.

To be erected upon the completion of the new school hall building (targeted for the end of 2013), the Wall of Stars is intended to be a permanent display on the wall of the new school hall building that will help to inspire future generations of Wahyanites to become *Men For and With Others*.

Samples of star-plates (actual size approx. 200mmWx100mmH):



Location of Wall of Stars

